

VOLANS PREMIUM Product Code **GT. Volans Premium 24v** (add suffix see below)

IP54 zone 2 **CE** **LED** IEE : A+ EN 60598.

DESCRIPTION / Linear flexible LED strip, 10mm wide with invisible Dow Corning resin coated IP54

Dimensions (mm)
4 (h) x 10 (width)

WHY USE THIS: Versatile (SMT) LED of high quality CRI90 and high performance. Very close pitch allows for 50mm cutting centres. Ideal for long runs. Fully dimmable and matched with many profiles suitable for all general lighting applications. Including wet areas.

Cut-out (mm)
N/A

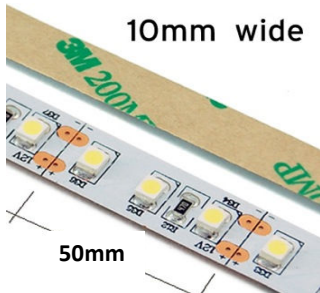

10MM PITCH, CUTTING CENTRES 50MM

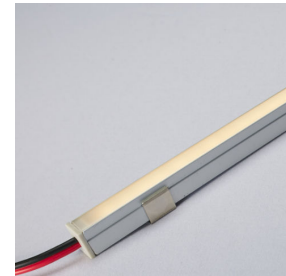

Contact us for the range of profiles

material light fixture PVC / plastic mix; copper conductors 4oz

colours & finish/ (suffix) Clear

light source & voltage options
(PLEASE CONTACT US FOR ALTERNATIVE SOURCES)

a) (2835) 5w/m LED 140deg (400 lms/m) 24v DC
b) (2835) 10w/m LED 140deg (800 lms/m) 24v DC
c) (2835) 15w/m LED 140deg (1150 lms/m) 24v DC
d)

120 LEDs/m

colour temperature /(suffix) **2400K*/2700K / 3000K / 4000K / 6000k* (*to order)**

CRI (colour render) /(suffix) 90+
MacAdam 3

Controls options /(suffix) phase dimming
DALI
0-10V

Optional Accessories See p.2 for available profiles
See p.3-4 for driver options

AV. Weight (kg) 0.04/m

Emergency Available? Yes

Special Notes **Supplied with 1m attached 'power-lead'. Cutting and soldering service available. Supplied with 3m tape as standard**

technical performance

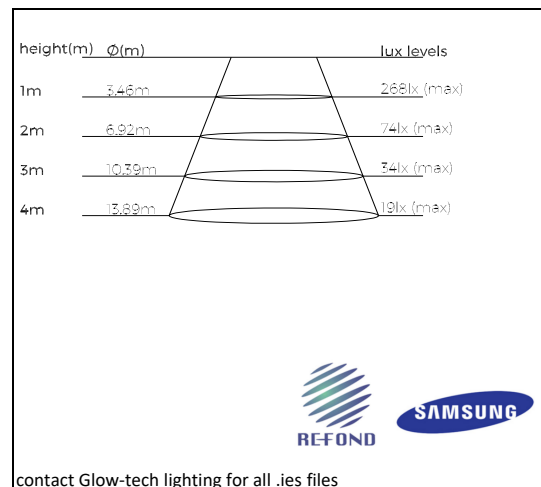

E.&O.E

PROFILES FOR VOLANS 10MM WIDE

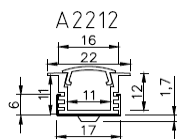

For routing
joinery

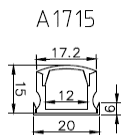

General
purpose - can
be trimless

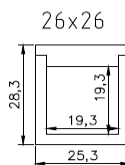

Outdoor sealed

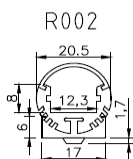

16x18mm



Sealed wet
areas

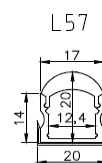

Lensed for partial
wall washing

Pivoting mount
for A1715



Coffers & shadow gap

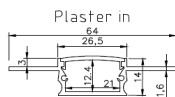

Trimless. Detail

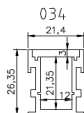

Outdoor
walk over
sealed.

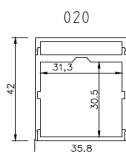

Any length
Ceiling surface
commercial
(suspended
available)

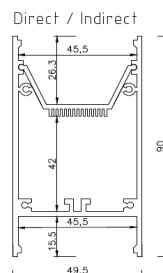

Any length
Suspended
Commercial

DRIVER OPTIONS DRIVER + DIMMING INTERFACE OPTIONS

Image	Code	dims	IP rating	Power	Inrush (A)	Comment
	GT.HLG-480-24 	262 X 125 X 43.8mm	IP65	480w	70A	For dimming use with MULTIPLE DT.ECP-701-8A below (additional in-rush current limiter available)
	GT.HLG-320 	252 X 69 X 45MM	IP67	320w	70A	POTENTIOMETER BUILT-IN For dimming use with MULTIPLE DT.ECP-701-8A below (additional in-rush current limiter available)
	GT.HLG-240 	247 X 69 X 39MM	IP67	240w	75A	POTENTIOMETER BUILT-IN For dimming use with MULTIPLE DT.ECP-701-8A below (additional in-rush current limiter available)
	GT.SL-24200D024	235 X 120 X 56MM	IP67	200w	75A	For dimming use with DT.ECP-701-8A below 2-CHANNELS OF 100W
	GT.SL-24150D024	235 X 120 X 56MM	IP67	150w	65A	For dimming use with DT.ECP-701-8A below
	GT.LPV-150 	191 X 63 X 37.5MM	IP67	150w	65A	For dimming use with DT.ECP-701-8A below
	GT.SL-24100D024	249 X 66 X 52MM	IP67	100w	60A	For dimming use with DT.ECP-701-8A below
	GT.LPV-100 	190 X 52 X 37.5MM	IP67	100w	75A	For dimming use with DT.ECP-701-8A below
	GT.SL-VB-240-60P	199 X 66 X 52MM	IP67	60w	55A	For dimming use with DT.ECP-701-8A below
	GT.LPV-60 	162 X 42.5 X 32MM	IP67	60w	60A	For dimming use with DT.ECP-701-8A below
	GT.SL-VB-240-30M	222x 29 x 20	IP67	30w	40A	For dimming use with DT.ECP-701-8A below
	GT.LPV-35 	148 X 40 X 30MM	IP67	30w	55A	For dimming use with DT.ECP-701-8A below
	GT.SL-VA-240-15U	222x 29 x 20MM	IP67	20w	35A	For dimming use with DT.ECP-701-8A below
	GT.ECP-701-8A	82 x 33 x 20mm	IP20	200W MAX 0-10V DIMMING INTERFACE		DIMS DOWN <10% FROM ZERO
	GT.ECP-701-12A	175 x 44 x 33	IP20	200W MAX 0-10V DIMMING INTERFACE		DIMS DOWN <10% FROM ZERO

DRIVER OPTIONS (continued)



**GT.ECP-701-8A-
DALI**
(DUAL OPERATION)
158x 50.5x 34

IP20

200W MAX DALI DIMMING INTERFACE
200W MAX DMX DIMMING INTERFACE

DRIVER OPTIONS TRIAC DIMMING DRIVER - ONE PIECE OPTIONS

Image	Code	dims	IP rating	Power	Inrush (A)	Comment
	GT.ELED-25-24-T	155 x 54 20	20	25w	35A	Works with leading edge TRIAC dimmers
	GT.ELED-50-24T	174x 61x 24mm	20	50W	50A	Works with leading edge TRIAC dimmers
	GT.ELED-80-24T	200x 68.5x 43	66	80W	55A	Works with leading edge TRIAC dimmers

SCHEMATICS

WIRING AS A RING CIRCUIT - OVER 5M

If LED strip is greater than 5m then circuit must be wired as a ring. Drivers can be mounted up to 20m away, provided the above is respected and 1.5mm cable used from the driver to the LED strip. In cases of drivers mounted over 10m from strip a bench test is recommended.

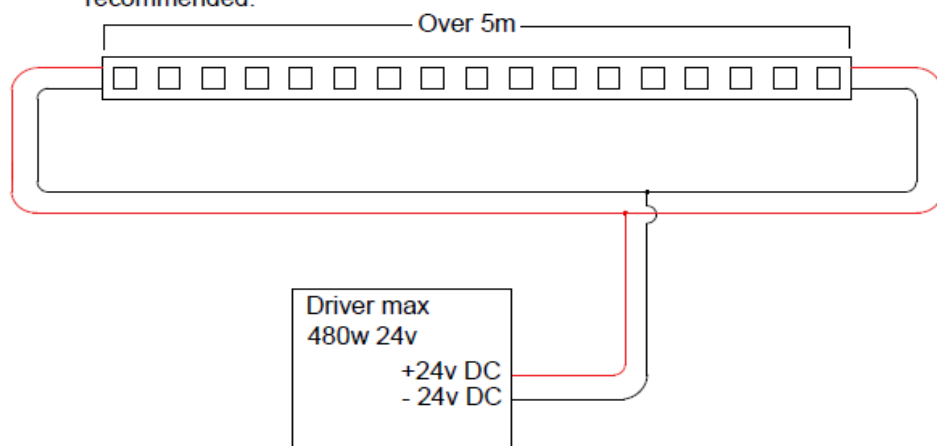

WIRING FOR 0-10V OR DALI DIMMING

This circuit is the standard layout for LED strip of 5m or less. for 5.1m - 10m strip should be fed from both ends (separate diagram available)

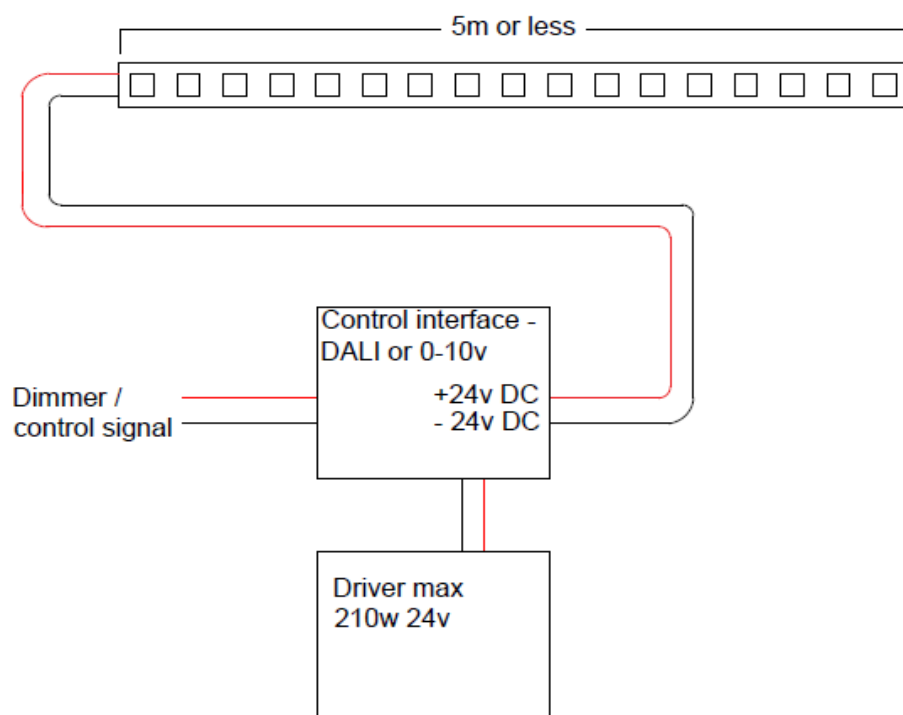

SCHEMATICS

WIRING FOR DMX INTERFACE CONTROL OF RGB

If LED strip is greater than 5m then circuit must be wired as a ring.
Drivers can be mounted up to 20m away, provided the above is respected and 1.5mm cable used from the driver to the LED strip. In cases of drivers mounted over 10m from strip a bench test is recommended.

